



## Flange ball valve KFK-BK, ductile cast iron, ceramic lining With DIN flange

**DN 50 - 125 mm PN 16 bar**

**Series** 25 – PN 10 according to DIN EN 1092-1

**Face-to-face lengths** DIN EN 558 FTF basic series 27 (formerly: DIN 3202-1 Series F4)

**Temperature range** Permissible operating temperature: -10°C to +160°C  
Other temperatures on request.

**Range of use** For abrasive materials. In addition, as a matter of principle, the resistance to the flow medium must be ensured.

**Technical specification** The KFK-BK type ball valve consists of a 2-part body. Up to nominal width DN 100, the half flange is screwed into the half body. From nominal width DN 125, the two body parts are flanged together. The stem is blowout-proof and is provided with a two-fold O-ring seal. Body, screw-in flange and ball are internally coated with the aluminium oxide ceramic material Alotec 92 and the seal is also manufactured from this material.

Please ask separately, where requirements exceed the standard conditions of use listed in this data sheet.

As a matter of principle, the operating and maintenance instructions, in particular the safety instructions must be observed!

Operating and maintenance instructions as well as the approval certificates can be downloaded at [www.von-scheven.de](http://www.von-scheven.de).

We reserve the right to carry out technical modifications.

## Technical data KFK-BK

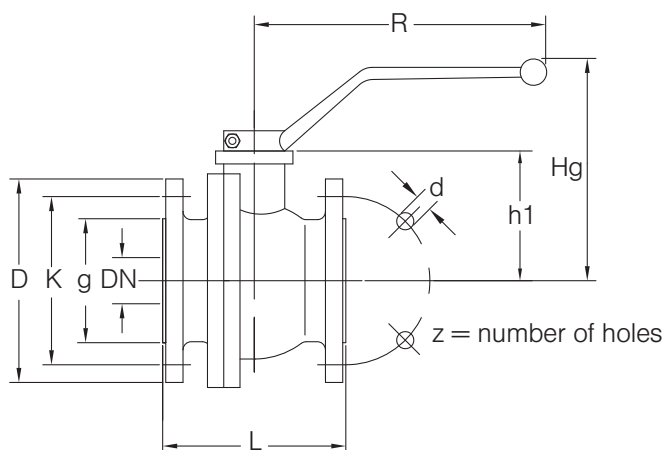
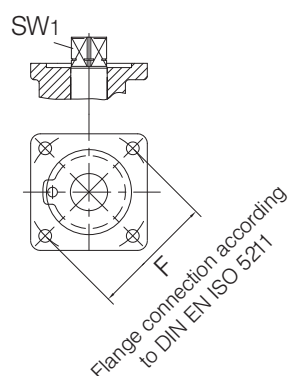

2-way ball valves  
with flange connection

## Series 26 (PN 16 according to DIN EN 1092-1)

| DN  | PN  | L   | D   | g   | K   | z | d  | Hg  | R   | h1  | F               | SW1 | Weight |
|-----|-----|-----|-----|-----|-----|---|----|-----|-----|-----|-----------------|-----|--------|
| mm  | bar | mm  | mm  | mm  | mm  |   | mm | mm  | mm  | mm  | DIN EN ISO 5211 | mm  | kg     |
| 50  | 16  | 150 | 165 | 102 | 125 | 4 | 18 | 128 | 250 | 71  | F07             | 17  | 13.0   |
| 65  | 16  | 170 | 185 | 122 | 145 | 4 | 18 | 158 | 250 | 101 | F07             | 17  | 20.5   |
| 80  | 16  | 180 | 200 | 138 | 160 | 8 | 18 | 182 | 368 | 131 | F10             | 22  | 29.5   |
| 100 | 16  | 190 | 220 | 158 | 180 | 8 | 18 | 194 | 358 | 144 | F10             | 22  | 36.0   |
| 125 | 16  | 325 | 250 | 188 | 210 | 8 | 18 | 195 | 500 | 163 | F10             | 22  | 50.0   |

**Example of order:** Ball valve type KFK-BK DN 100 with flanged connection PN 16 according to DIN EN 1092-1, internally coated with aluminium oxide ceramic material  
**KFK-BK 100 26**

## Parts list KFK-BK

| Pos. | Designation   | Material*                 |
|------|---|---------------------------|
| 10   | Body  | Casting                   |
|      | Internally coated with aluminium oxide ceramic material |                           |
| 20   | Flange  | Casting                   |
|      | Internally coated with aluminium oxide ceramic material |                           |
| 30   | Ball  | Stainless steel           |
|      | Internally coated with aluminium oxide ceramic material |                           |
| 40   | Seal  | ALOTEC 92                 |
| 41   | O-ring  | NBR                       |
| 42   | O-ring  | NBR                       |
| 50   | Stop washer   |                           |
| 60   | Stem  | Steel                     |
| 80   | O-ring  | NBR                       |
| 90   | Hand lever  | Zinc die-casting, casting |
| 100  | O-ring  | NBR                       |
| 130  | Sliding ring  | PTFE                      |
| 140  | Stop pin  |                           |
| 160  | Bolt  |                           |

\*Standard (can vary according to nominal width), other materials on request.

